

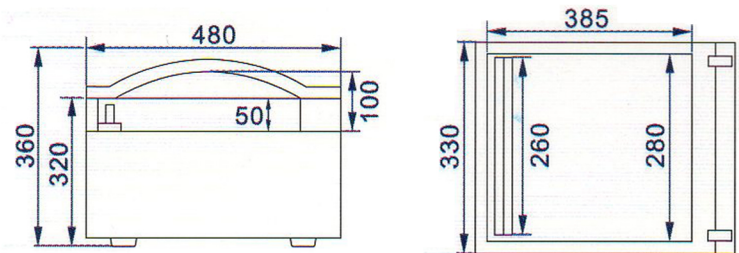

**BELTER-10 VACUUM SEALER**



**BELTER 10” MACHINE DIMENSION**

<b>MODEL VACUUM SEALER</b>	BELTER-10
Machine Type	Table Type
Sealer Volume	1 Sides
Sealer Dimensions	10”
Bag Weight	Rice Bag 1 - 2 Kg Square Seals and Flat Seals Can pack 1 time Sealing
Chamber Dimensions	385 x 280 x 50 mm.
Bag Shape	Flat Shape Rice Bags And Square Seals
Electrical Requirement	220V / 50 Hz
Pump Power Consumption	0.37 Kw
Sealer Power Consumption	0.40 Kw
Pressure	1.33 Kpa
Vacuum Pump	10 m <sup>3</sup> /Hr
Machine Body Material	Stainless
Machine Dimensions	480 x 330 x 360 mm.
Net Weight	35 kg.